

CARIBBEAN 26 - Flybridge Sportsfisherman

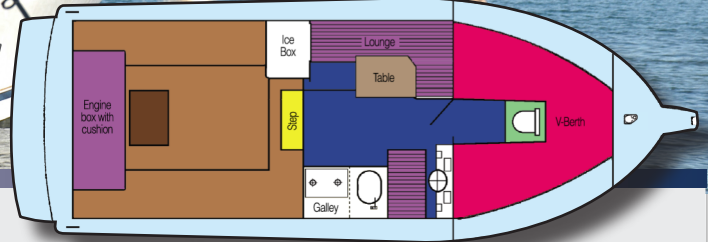

SPECIFICATIONS

POWER:

- Dual Petrol Sterndrive Engines
- Net Weight - 2859kg
- Sleeping - 2/4
- Length Overall - 7.29m (26') plus Swimming and Bow Platforms
- Height Above Waterline - 2.35m (8'2") (Excluding Targa/ Bimini Top)
- Beam - 3.02m (9'11")
- Cockpit Area - 11.2sq. m. (120sq. ft.)
- Cruise Speed - 20 - 25 knots

STANDARD EQUIPMENT

Mechanical and Electrical:

- Flybridge and lower control stations with dual lever controls, hydraulic steering and comprehensive instrumentation.
- Electric power trim.
- Two 70 amp/hr batteries with isolating switches.
- Water separating fuel filters.
- Electric bilge blower.
- Automatic electric bilge pump.
- Electric fuel gauge and engine hour meters.
- Dual windscreen wipers.
- Navigation and anchor lights.
- 12 volt switch board with protection fuses.
- 12 volt wiring and lighting throughout.
- Pressurised water system.
- 500 litre fuel tank with dipstick.
- Dual mercathode engine protection system.
- Dual on-board sterndrive oil bottle reservoirs.
- 12 volt reversing anchor winch, operational from both stations and foredeck.

Forward Cabin:

- Self draining chain locker with access door.
- Dual V-berths with fill in cushions for conversion

to double bed and storage under.

- Upholstered side trays.
- Carpeted throughout.
- Full bulkhead with lock up door.
- Full flush marine toilet.
- Toilet roll holder.
- 12 volt quartz halogen lighting.
- Overhead deck hatch.

Main Cabin:

- Armour plate front windows with acrylic sliding side windows.
- 12 volt quartz halogen lighting.
- 132 litre water tank.
- Underfloor storage locker.
- Carpeted side storage pockets.
- Galley unit featuring twin burner spirit stove, fire extinguisher, stainless steel sink and electric water system.
- L-Shaped dinette unit with seating for four.
- Helmsman seat with storage locker under.
- Comprehensive lower station.

Cockpit:

- Fibreglass non-skid floor with inspection hatch.
- Fibreglass engine box.
- Engine box cushion.
- Upholstered side panels raised for placement of feet under and easy access to hull sides.
- Deck side storage compartments.
- Fibreglass swimming platform.
- 12 volt cockpit light.
- Rod/Gaff storage racks.
- Flush mounted cockpit shower in transom panel.

Deck:

- Bow platform with automatic anchor raising system, footswitch, anchor and chain.
- Mooring cleats forward and aft.
- Stainless steel bow rail.
- Deck fuel filler.
- Heavy duty aluminium rubbing strip.
- Non-skid deck.

Flybridge:

- Acrylic deflection screen.
- Stainless steel safety rails.
- Stainless steel flybridge ladder with heavy duty steps.
- Vinyl upholstered fibreglass seat incorporating storage locker.
- Fibreglass footrest.
- Forward storage lockers with hinged doors.
- Flybridge cover.
- Flush mount compass.
- Dual horns with flybridge and lower station controls.
- 12 volt power socket.
- Full stainless steel targa bimini with envelope.
- Colour co-ordinated flybridge, deck & chine lines.

Optional Accessories:

The CARIBBEAN 26 Flybridge Sportsfisherman is also available as an Open Sports, and a Flybridge Sportsfisherman. Full details of these models and a comprehensive range of optional accessories may be obtained from **Gameboats**.

" THE BOATS THE EXPERTS ARE BUYING "

GAMEBOATS

2a McCarrs Creek Road Church Point NSW 2105 - Telephone: 02.9979.5922 Fax: 02.9979.5962
email: sales@gameboats.com.au - web: www.gameboats.com.au